

Machine control with the Ceramill Go App

CERAMILL GO V2

Machine control via the Ceramill GO app

- RESET MACHINE MESSAGES
- DELETING A JOB
- INITIALIZING THE MACHINE
- OPENING THE SAFETY DOOR
- STARTING A JOB
- ADJUSTING THE TOOL WEAR LIMIT
- PRIORITIZING JOBS
- DISPLAYING MACHINE DETAILS
- RESET JOB
- MOVE SW REQUIREMENTS

RESET MACHINE ALERTS

Reactivating the machine after an error situation

- Reset error messages / warnings / notes to continue working
- For example, after a loss of compressed air

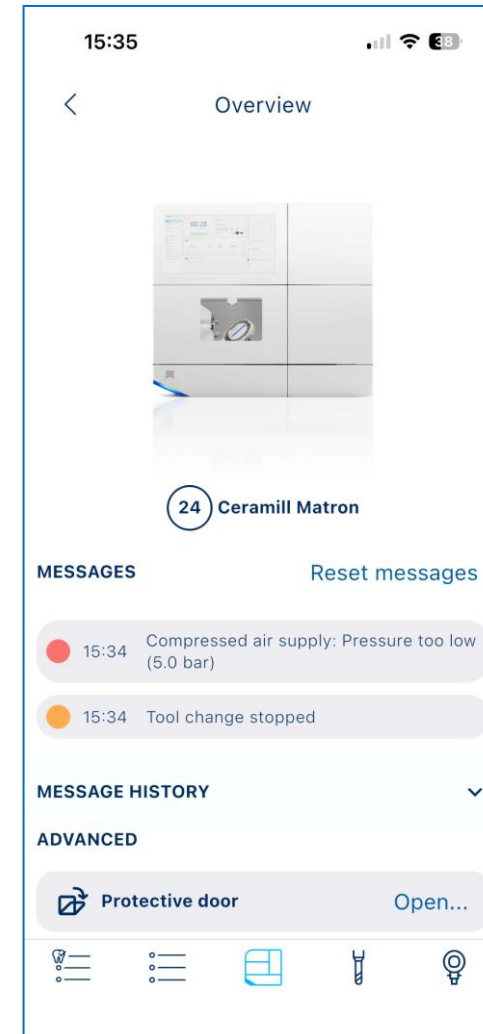

INITIALIZING THE MACHINE

Reactivate the machine in case of a target/actual deviation

- After receiving an error message indicating a target/actual deviation of the axes
- Reset the error message to continue working
- Switch to the current job
- Start initialization
- Restart the first job in the job list

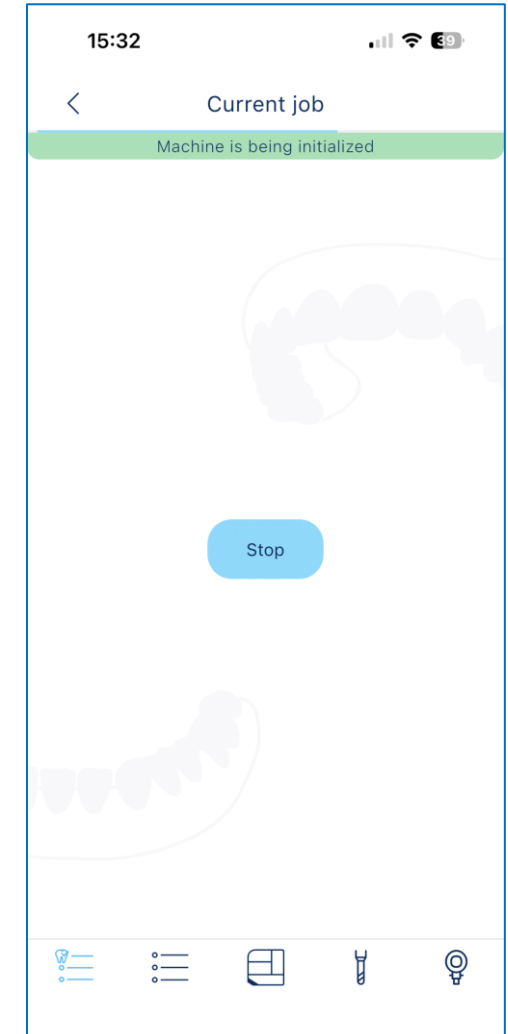
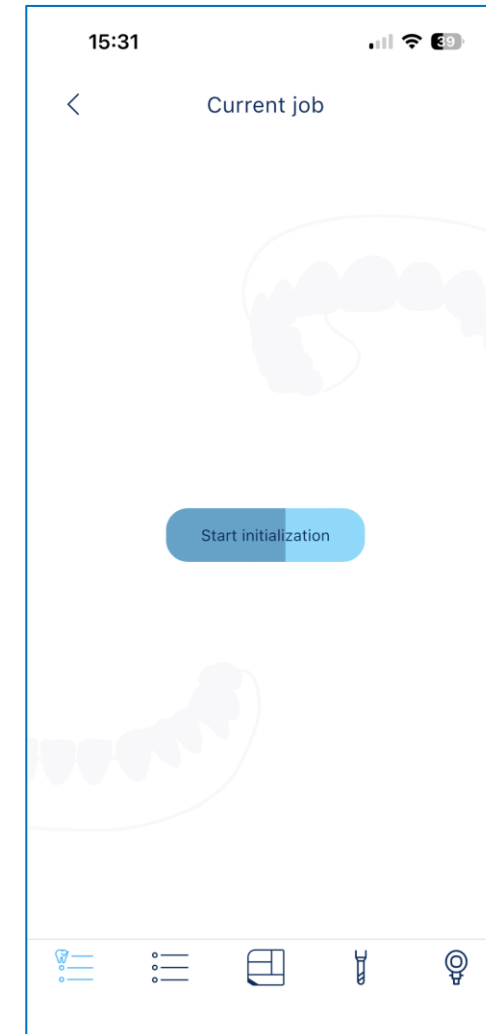
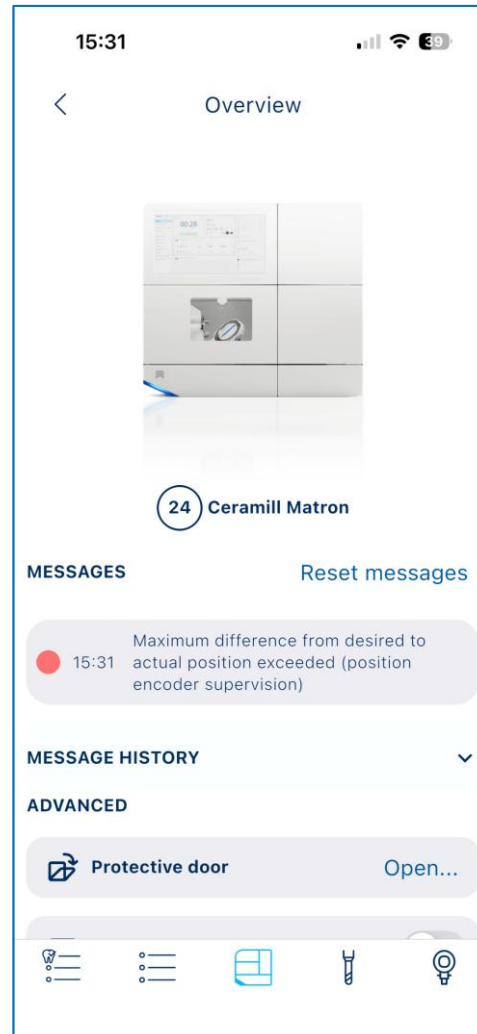

- Starting an active milling job.
 - Functionally equivalent to pressing the Start/Stop button on the HMI
- Hold the Start button down for 2 seconds
 - The hold-to-confirm function prevents accidental activation of the function
 - Visible countdown
- Stopping a job interrupts the process just like on the HMI

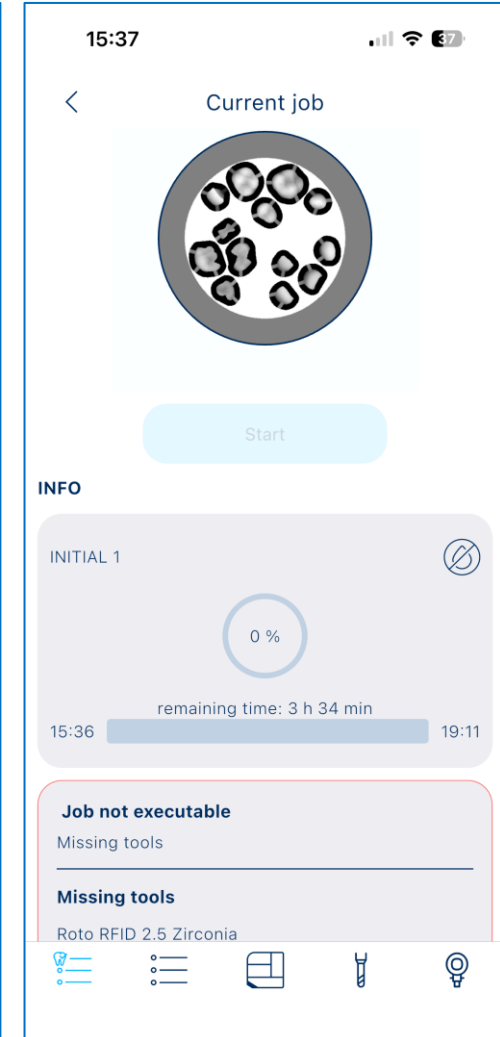
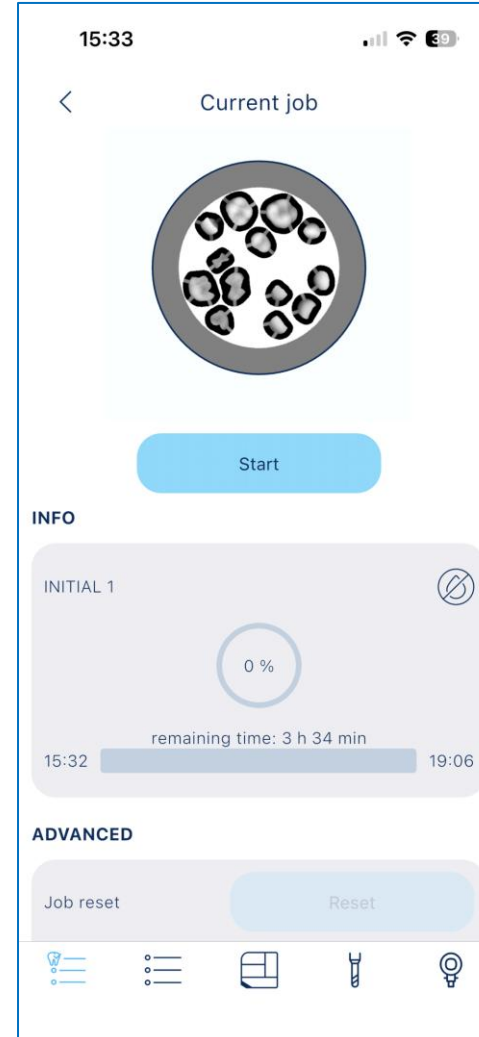

JOB MANAGEMENT – CHANGE JOB ORDER

Prioritize jobs & change the job order

- Influencing the order of jobs
- Reorganizing jobs via drag & drop
- Cleaning jobs move automatically as they are controlled by the machine
- A running job is not interrupted

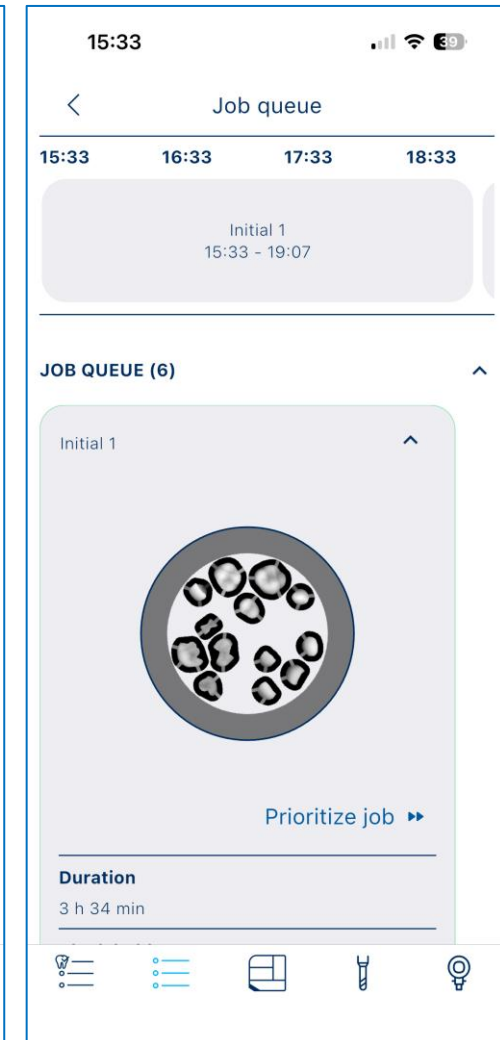
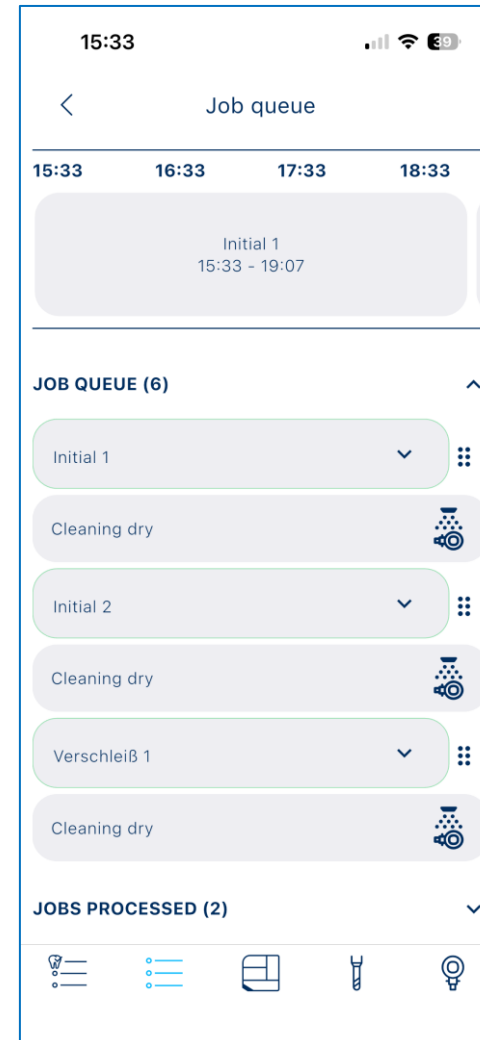

JOB MANAGEMENT – RESET JOB

Reset job

- Stop the job and reset it to Start because you want to prioritize and start another job
- The job can be processed again later starting from the beginning

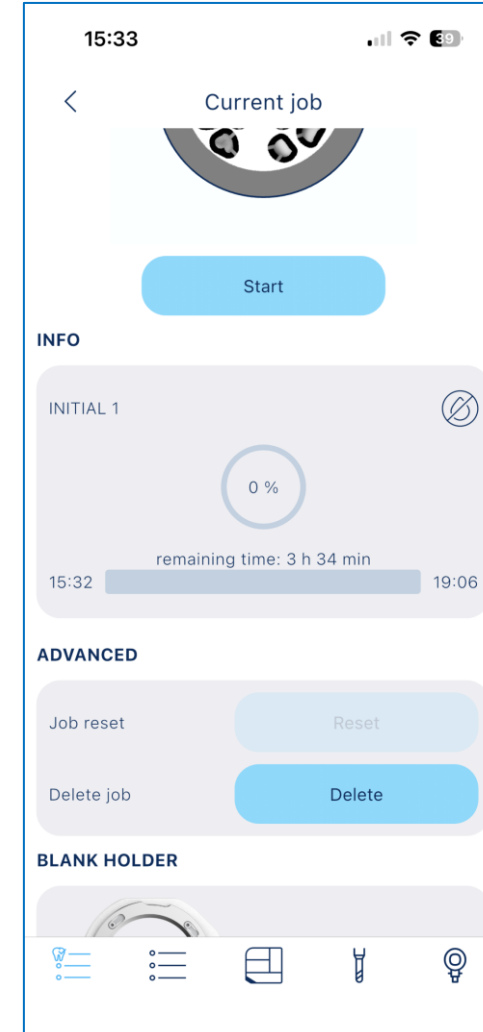

JOB MANAGEMENT - DELETE JOB

Delete job

- Deletes selected jobs from the queue
- Hold down the Start button for 2 seconds
 - The hold-to-confirm function prevents accidental activation of the function
 - Visible countdown

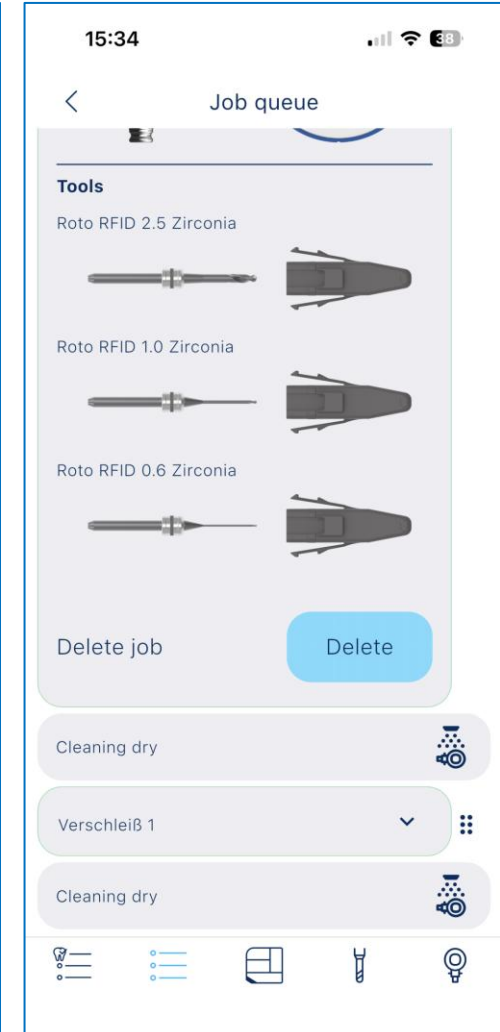
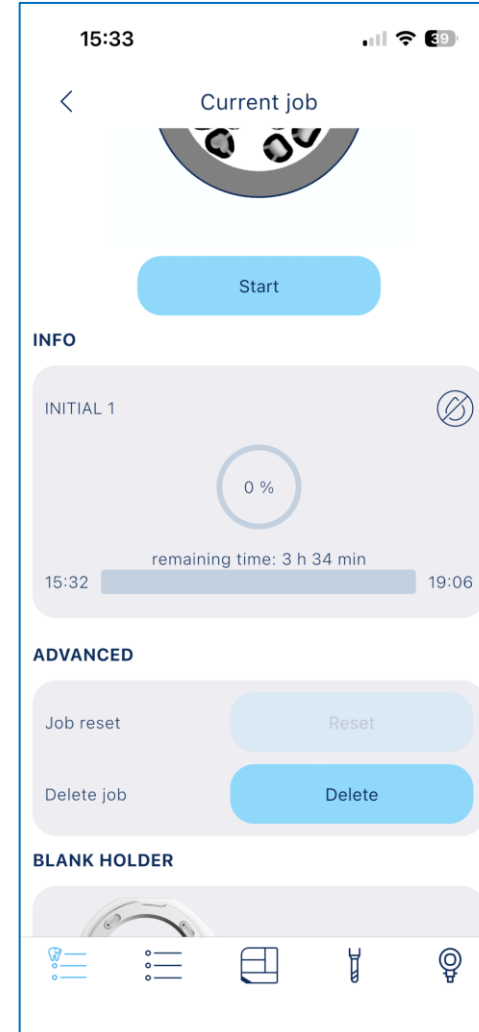

OPEN THE SAFETY DOOR

Open the safety door to allow the machine interior to dry out overnight

- The machine's last job is a wet machining operation, and the machine interior needs to dry overnight after this job
- To do this, open the safety door using the app
- A message appears on the machine HMI indicating that the door will open in 10 seconds
- Now, dry machining jobs—such as zirconium—can be started right away the next day. This prevents milling dust from sticking heavily to the interior
- **ATTENTION:**
The open door can no longer be closed via the app

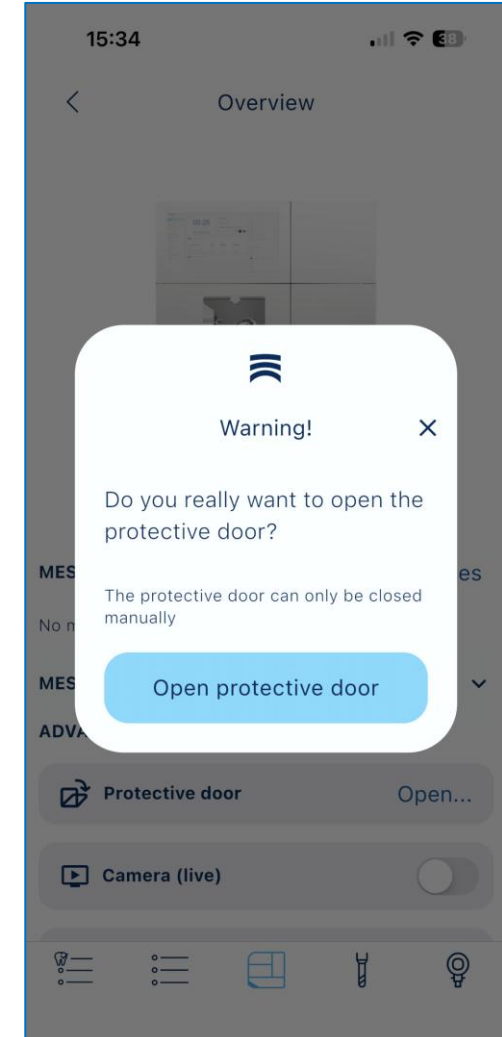
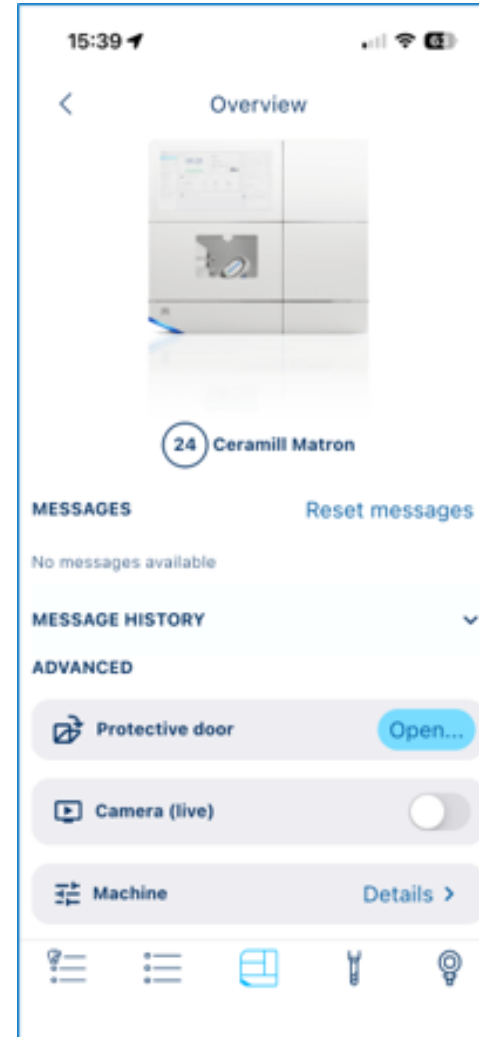

ADJUST THE TOOL WEAR LIMIT

- Adjusting the wear limit from 100% to a maximum of 300% in 10% increments is possible, as on the HMI
- e.g., temporarily continuing to use tools to complete the last jobs in the queue

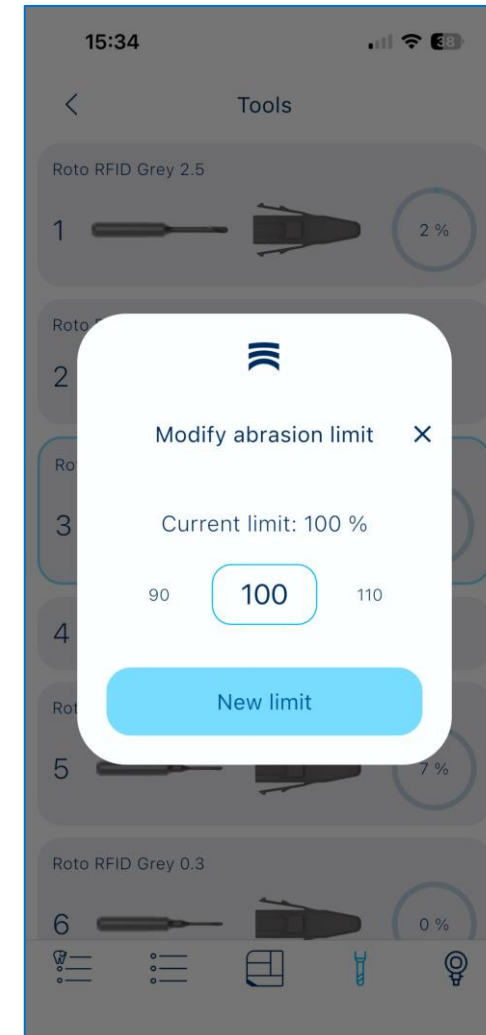

VIEW MACHINE DETAILS

Information display

- Information display of:
 - Serial number
 - HMI version
 - Axis runtime (operating hours)
 - Coolant pump runtime
 - Spindle runtime since last collet cleaning



- Machine control via the Ceramill GO app is available starting with Move version 19.28 and higher
- If an older Move version is used, the machine control functions will not be displayed in the app, and machine control will therefore not be possible